



**CETOP 3 SUBPLATES**

BS.3.01... / BS.3.0\*... CH. VII PAGE 7

BS.3.10/11... / BS.3.12/13... CH. VII PAGE 8

BS.3.14/15... / BS.3.16/17... CH. VII PAGE 8

BS.3.20/21... / BS.VMP.10... CH. VII PAGE 9

BS.3.W... CH. VII PAGE 9

BC.3.25/27... / BC.3.30/32... CH. VII PAGE 10

BC.3.40... CH. VII PAGE 10

BC.3.41/\*... CH. VII PAGE 11

BC.3.50... / BC.3.51... CH. VII PAGE 12

BC.3.07... / BC.3.107... CH. VII PAGE 12

BC.3.08... / BC.3.09... CH. VII PAGE 13

BC.06.XQ3... / BC.06.XQP3... CH. VII PAGE 13

BC.06.25/27... CAP. VII PAGE 14

BC.06.30/32... / BC.06.40... CH. VII PAGE 15

BC.06.41/\*... CH. VII PAGE 15

BM.3.\*\*... / BM.3.60... CH. VII PAGE 16

BM.3.50... / BM.3.70... CH. VII PAGE 17

BM.3.52... / BM.3.72... CH. VII PAGE 18

CMP.10... CH. V PAGE 19

XQ.3... CH. VIII PAGE 12

XQP.3... CH. VIII PAGE 14

**BS.3.01...**

- BS** Single subplate (blanking)
- 3** CETOP 3/NG6
- 01** P / T / A / B closed
- 00** No variant
- 1** Serial No.

Weight: 0,2 Kg  
 Fixing screws M5x14 UNI 5931  
 K = plate OR (Q25.95.0001)

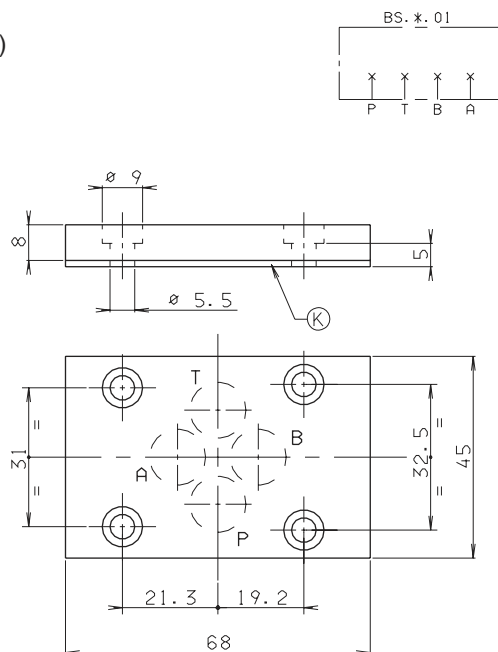

**BS.3.\*\* ...**

- BS** Single subplate (blanking)
- 3** CETOP 3/NG6
- \*\*** **02/03/04/05/06/07/08/09**
- 00** No variant
- 1** Serial No.

Weight: 0,5 Kg  
 Fixing screws M5x30 UNI 5931

